

Application

Control pushbuttons of SP22 Series are used for making and breaking circuits of up to 2.5 A, in visual and audible signalization in machine panels and control boards. Control pushbuttons and indicator lamps SP22 have modular construction. Types of functional modules of a pushbutton are shown in Fig. A. Control pushbuttons and indicator lamps SP22 are delivered as complete products or functional modules. Modular construction of pushbuttons and lamps allows to create required functional variants of devices or making changes in existing control circuits. Control pushbuttons SP22 can be mounted in standard openings of 22.3 mm diameter in control or signalization panels or directly in the body of a machine or device. The upper parts of the pushbuttons are black or satin nickel plated.

Fig. A
Functional elements of pushbuttons and lamps

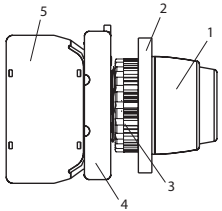

1. Actuator or lamp holder
2. Panel
3. Ring nut
4. Holder
5. Switch or lamp holder

Spacing of the holes in the panel, recommended by PN-EN 60947-5-1

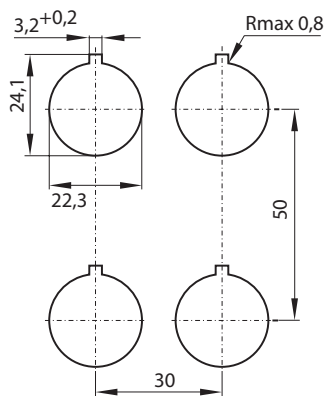

Spacing of the holes in the panel, maximum

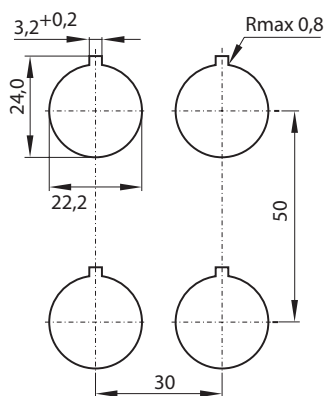

Assembly

Control pushbuttons and indicator lamps are mounted in control panel openings. Insert the actuator (1) into the standard hole in the panel (2), fasten the ring nut underneath the panel (3) to fix the actuator (1) Fig. B. Then snap the holder (4) on the actuator (1) making sure that positioning arrows are matched as shown in Fig. C. The switches (5) are snapped onto the holder (4) Fig. D. Up to 6 switches can be mounted to the holder (4) or 1 to 4 in the illuminated version Fig. E.

Fig. B
Position of the actuator (lamp holder) in the panel

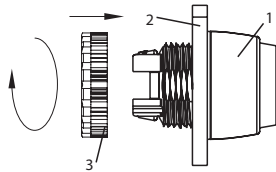

Fig. C
Assembling the holder with the actuator

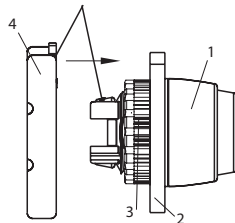

Fig. D
Assembling the switch with the holder

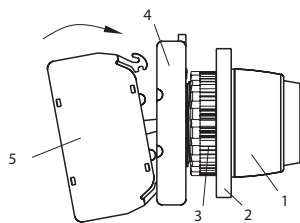
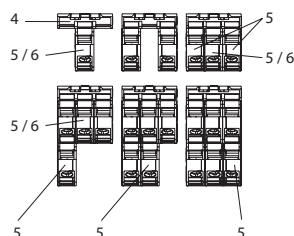

Fig. E
Assembling the switches or a lamp holder with the holder



1. Actuator or lamp holder
2. Panel
3. Ring nut
4. Holder
5. Switch
6. Lamp holder

Disassembly

To remove a pushbutton or an indicator lamp SP22 from the control panel:

- 1)** To remove the switches (5) or a lamp from the holder (4) lever the fixing catch (5) with a screwdriver and pull back the switch from the holder. Fig. F
- 2)** Put a slot head screwdriver in the eye of the holder (4), lever it slightly and pull the holder back. Fig. G
- 3)** Unscrew the ring nut (3) to remove the actuator (1) from the control panel (2) Fig. H

Fig. F
Disassembling the switch or the lamp holder from the holder

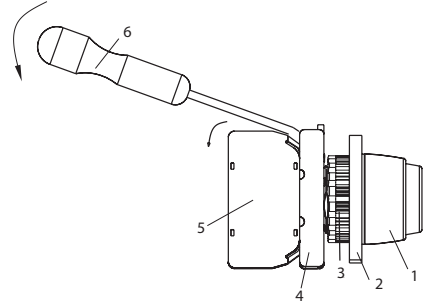

Fig. G
Disassembling the holder

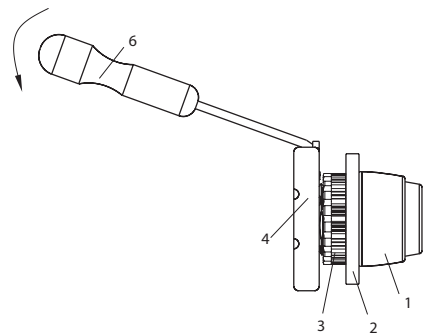
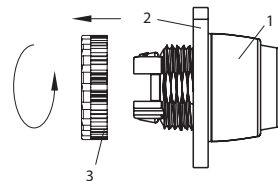
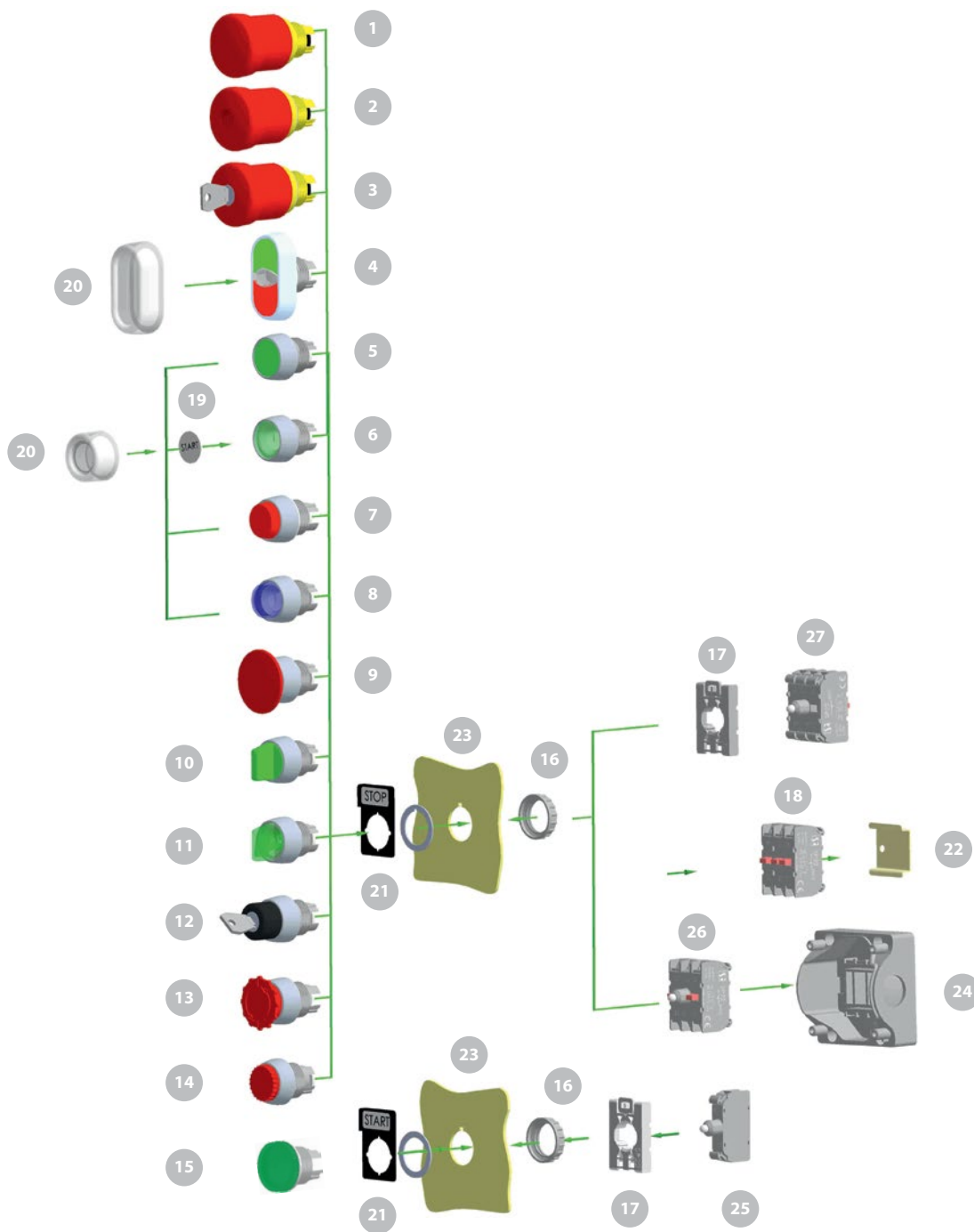

Fig. H
Disassembling the actuator from the panel



1. Actuator
2. Panel
3. Ring nut
4. Holder
5. Switch
6. Screwdriver



Element	Catalogue code
1. Emergency actuator, standard	SP22-BN ...
2. Illuminated emergency pushbutton actuator, standard	SP22-BLN ...
3. Emergency actuator, lockable	SP22-BSN ...
4. Actuator with twin pushbutton	SP22-2KL ...
5. Flush pushbutton actuator	SP22-K ...
6. Illuminated flush pushbutton actuator	SP22-KL ...
7. Raised pushbutton actuator	SP22-W ...
8. Illuminated raised pushbutton actuator	SP22-WL ...
9. Mushroom head pushbutton actuator	SP22-D ...
10. Knob-operated selector switch actuator	SP22-P ...
11. Illuminated knob-operated selector switch actuator	SP22-PL ...
12. Key-operated selector switch actuator	SP22-S ...
13. Emergency actuator	SP22-B ...

Element	Catalogue code
14. Actuator with raised pushbutton, latching	SP22-WR ...
15. Holder	SP22-L ...
16. Nut (included)	ST22-6608\PO2
17. Holder	SP22-6625\PO1
18. Switches	SP22\10 or SP22\01-sz
19. Insert label with lettering	ST22-7202\ ...
20. Hermetic caps	ST22-7608, ST22-7606
21. Legend plate	ST22-1901\ ...
22. Rail	-
23. Panel	-
24. Control station	SP22K ... \ ...
25. Lamp holder, standard	SP22-1408\P...
26. Rail lamp holder + 2 rail switches	
27. Standard lamp holder + 2 switches	