

Cam switch with module masking plate SK40 S10



Ordering code

SK 40 - \S10

| | | Assembly number |
|---------------|---------|-------------------------------|
| 1.825 | | Disconnecter 0-1 (1 - pole) |
| 1.828 | | Disconnecter 0-1 (2 - pole) |
| 2.8211 | | Disconnecter 0-1 (3 - pole) |
| 2.8210 | | Disconnecter 0-1 (4 - pole) |
| 1.834 | | Disconnecter 1-0-2 (1 - pole) |
| 2.8338 | | Disconnecter 1-0-2 (2 - pole) |
| 40 | Current | 40 A |

Dimensions

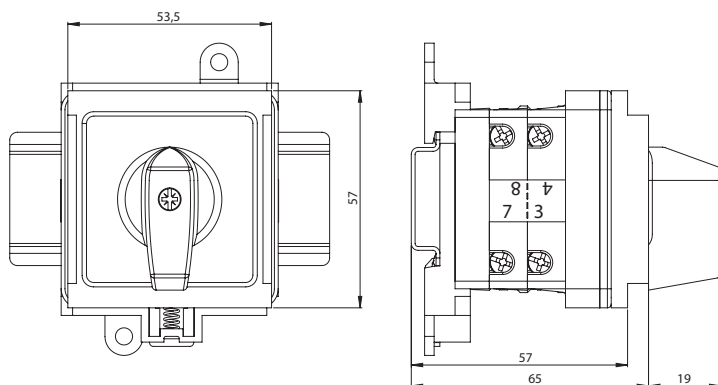

Number of segments in the switch

2 ... 2

Technical data

| | |
|---|--|
| Rated insulation voltage U_e | 690 V |
| Rated withstand impulse voltage U_{imp} | 6 kV |
| Rated continuous current $I_u=I_{th}$ | 50 A |
| Rated operational current I_e for AC-21A, AC-22A | 40 A (230/400/500/690 V) |
| Rated operational power P_e for AC-23A | 9 kW (230 V) 15 kW (400 V) 18.5 kW (500 V) 26 kW (690 V) |
| Rated operational power P_e for AC-3 | 7.5 kW (230 V) 12 kW (400 V) 15 kW (500 V) 21 kW (690 V) |
| Rated operational current I_e for DC-21A | 40 A (24 V) 20 A (110 V) 15 A (220 V) |
| Short-time short-circuit withstand current $I_{cw}(1s)$ | 0.5 kA |
| Rated short-circuit making current I_{cm} | 0.7 kA |
| Rated conventional short-circuit current | 10 kA |
| Rated current fuse link gG | 50 A |
| Wire gauge | 4...10 mm ² |
| Tightening torque, terminals | 1.2 Nm |
| Panel mounting | □48 |
| Mechanical endurance | 3.0 mln (transposition cycles) |
| Ambient temperature | -40 ... +70°C (work) -40 ... +70°C (storage) |
| Protection level: PN-EN 60529 to the panel | IP65 |
| Protection level of OB enclosure | IP65 |
| Vibration test (acc. to IEC 60068-2-6) | 2...13, 2...100 Hz (frequency) ± 1 mm (acceleration amplitude) ±0.7 g (acceleration amplitude) |
| Shock test (acc. to IEC 60068-2-27) | 15 g (peak acceleration) 11 ms (impulse duration) |
| Damp heat cyclic test (acc. to IEC 60068-2-30) | 55°C (ambient temperature) 95% (relative humidity) |
| Salt mist cyclic test (acc. to IEC 60068-2-52) | severity 1 |